

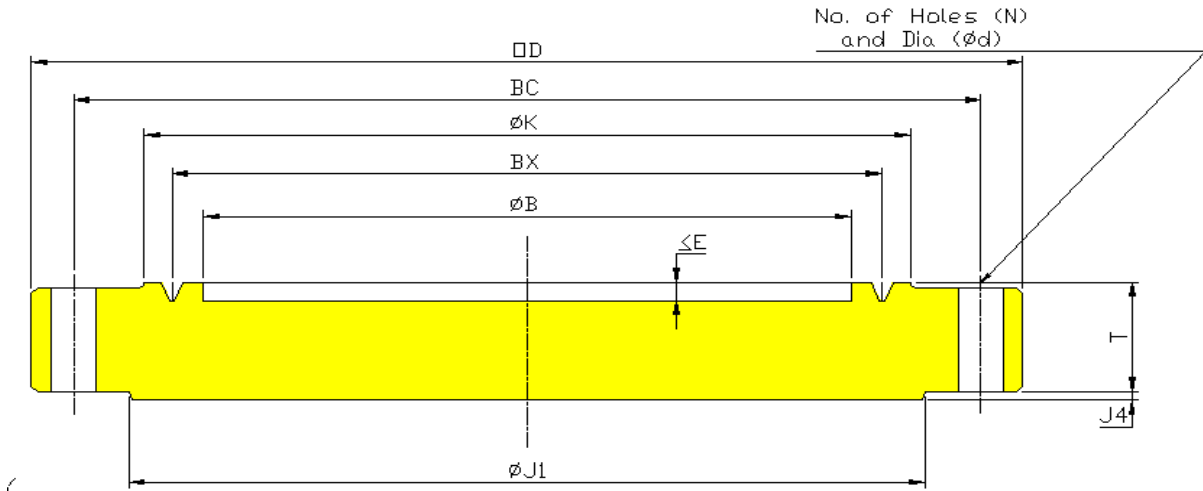

SANKALP FORGINGS PVT. LTD.

Gat No. : 1039/1, & 1093/2, Chakan-Shikrapur Road, Karandi, Tal -Shirur, Dist- Pune - 412 208, Maharashtra, India

FLANGES (AS PER API 6A)



BLIND FLANGE

2000 PSI WP WITH BX RING GROOVE											
SIZE	OD	Ø k	T	Ø J1	BC	N	Ød	BX	B	J4	E
26 -3/4	41.00	31.69	4.97	32.91	37.50	20	1.88	167	26.75	0.38	0.844
30"	44.19	35.75	5.28	36.69	40.94	32	1.75	303	30.00	0.69	0.906
3000 PSI WP WITH BX RING GROOVE											
26 -3/4	43.38	32.75	6.34	34.25	39.38	24	2.12	168	26.75	0.00	0.844
30"	46.68	36.31	6.58	38.19	42.94	32	2.00	303	30.00	0.50	0.906
5000 PSI WP WITH BX RING GROOVE											
13-5/8	26.50	18.00	4.44	18.94	23.25	16	1.75	160	13.63	0.94	0.562
16-3/4	30.38	21.06	5.12	21.88	26.62	16	2.00	162	16.75	0.69	0.328
18-3/4	35.62	24.69	6.53	26.56	31.62	20	2.12	163	18.75	0.75	0.719
21-1/4	39.00	27.62	7.12	29.88	34.88	24	2.12	165	21.25	0.88	0.750
10000 PSI WP WITH BX RING GROOVE											
SIZE	OD	Ø k	T	Ø J1	BC	N	Ød	BX	B	J4	E
5-1/8	14.06	8.69	3.12	8.81	11.81	12	1.25	169	5.13	0.25	0.375
7-1/16	18.88	11.88	4.06	11.88	15.88	12	1.62	156	7.06	0.38	0.438
9	21.75	14.12	4.88	14.75	18.75	16	1.62	157	9.00	0.38	0.500
11	25.75	16.88	5.56	17.75	22.25	16	1.88	158	11.00	0.56	0.562
13-5/8	30.25	20.38	6.62	21.75	26.50	20	2.00	159	13.63	0.69	0.625
16-3/4	34.31	22.69	6.62	25.81	30.56	24	2.00	162	16.75	1.19	0.328
18-3/4	40.94	27.44	8.78	29.62	36.44	24	2.38	164	18.75	1.00	0.719
21-1/4	45.00	30.75	9.50	33.38	40.25	24	2.62	166	21.25	1.25	0.750
15000 PSI WP WITH BX RING GROOVE											
5-1/8	16.50	8.88	3.88	9.62	13.50	12	1.72	169	5.13	0.25	0.375
7-1/16	19.88	12.00	4.69	12.81	16.88	16	1.62	156	7.06	0.31	0.438
9	25.50	15.00	5.75	17.00	21.75	16	2.00	157	9.00	0.56	0.500
11	32.00	17.88	7.38	23.00	28.00	20	2.12	158	11.00	0.50	0.562
13-5/8	34.88	21.31	8.06	23.44	30.38	20	2.38	159	13.63	0.69	0.625
18-3/4	45.75	28.44	10.06	32.00	40.00	20	3.12	164	18.75	1.38	0.719
20000 PSI WP WITH BX RING GROOVE											
7-1/16	25.81	13.88	6.50	15.19	21.81	16	2.12	156	7.06	0.31	0.438
9	31.69	17.38	8.06	18.94	27.00	16	2.62	157	9.00	0.25	0.500
11	34.75	19.88	8.81	22.31	29.50	16	2.88	158	11.00	0.50	0.562
13-5/8	45.75	24.19	11.50	27.31	40.00	20	3.12	159	13.63	0.56	0.625